

[www.moulinex.com](http://www.moulinex.com)

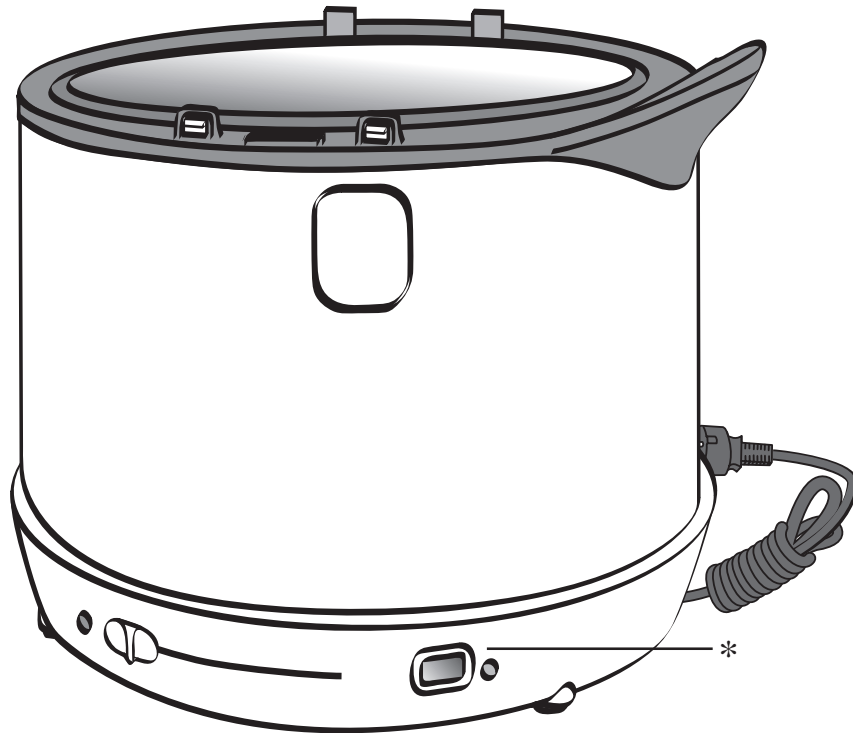

\*selon modèle • depending on model • je nach Modell • a seconda del modello • según modelo • consoante os modelos • Ανάλογα με το μοντέλο • В зависимости от модели • Залежно від моделі • zależnie od modelu • az egyes modellek szerint • podle modelů • podľa modelov • В зависимости от модели • În funcție de model • modellere göre • Зависно од модела • zavisno od modela • Ôlede na model • بر حسب مدل • حسب الموديل

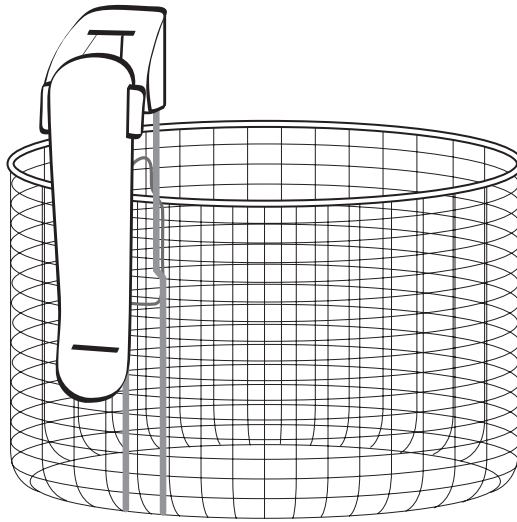

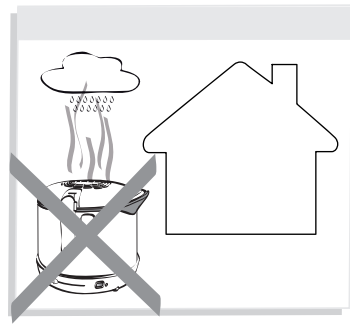
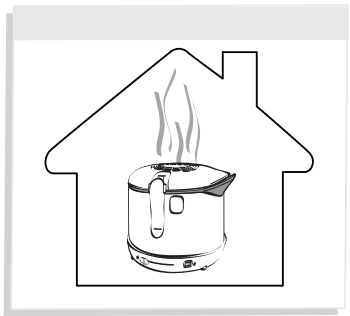
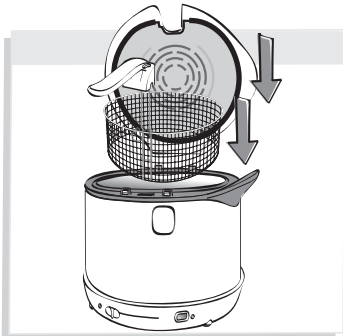
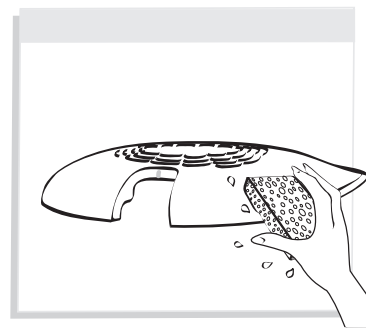
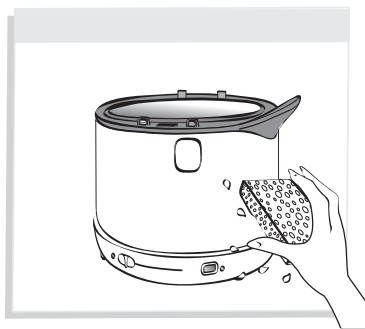
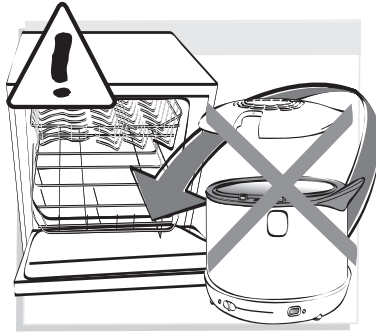
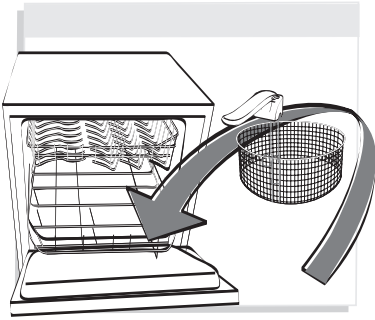
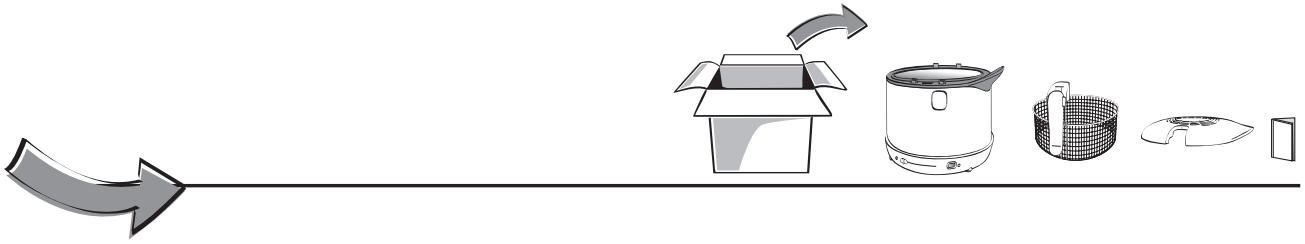



Min 2L  
Max 2,2L

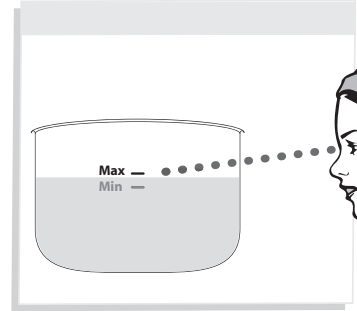

Min 1 750 g  
Max 2 000 g

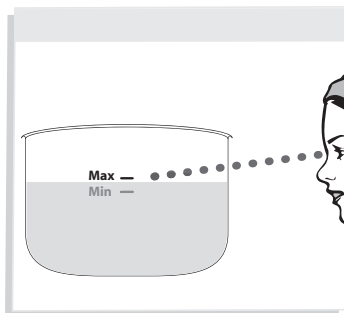
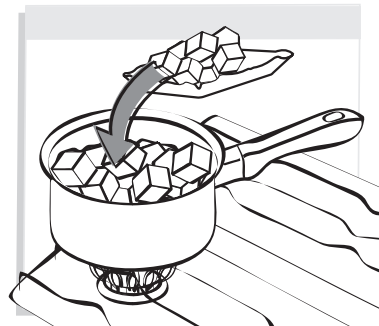

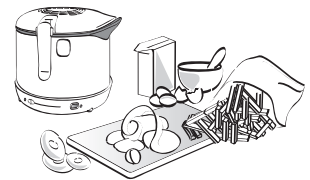

Max 1000 g  
500 g

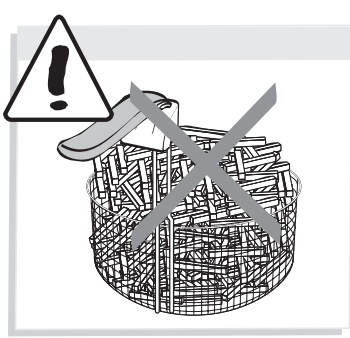
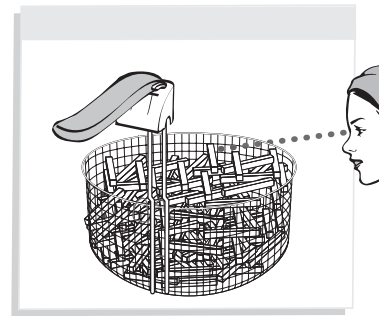
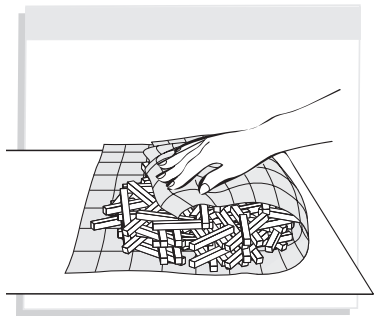



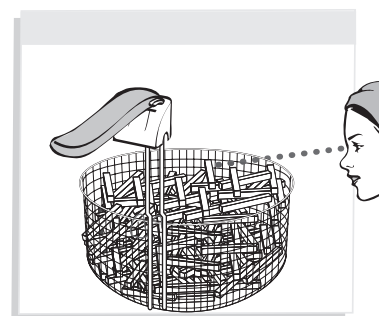
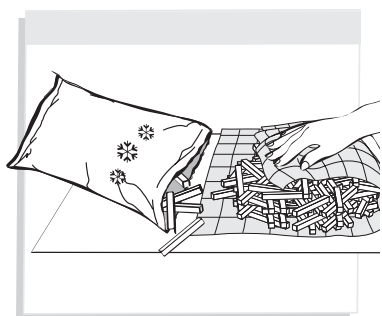

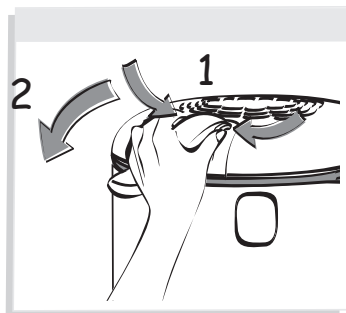
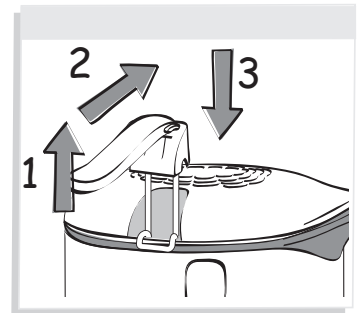
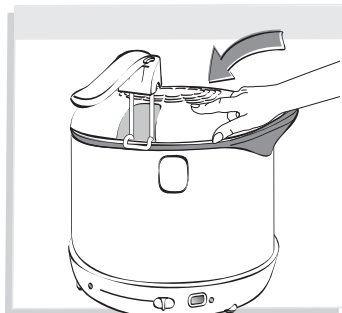
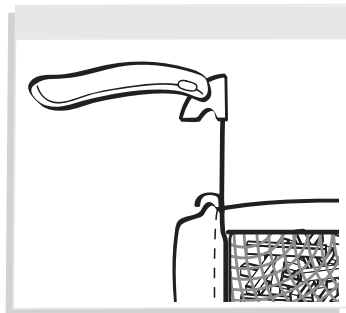
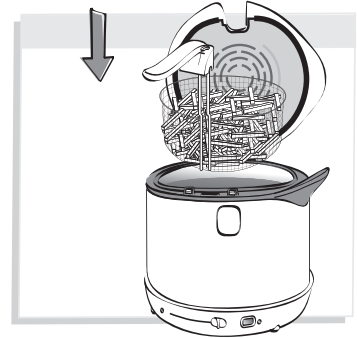
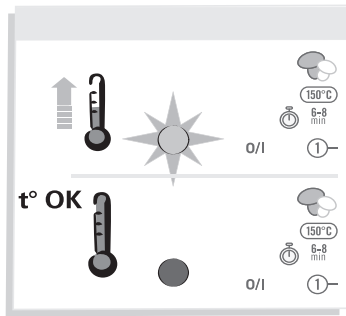
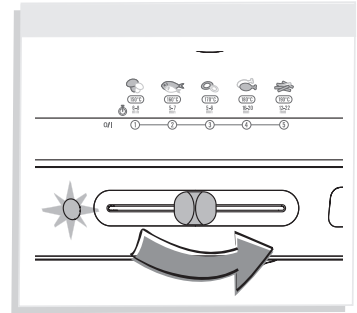
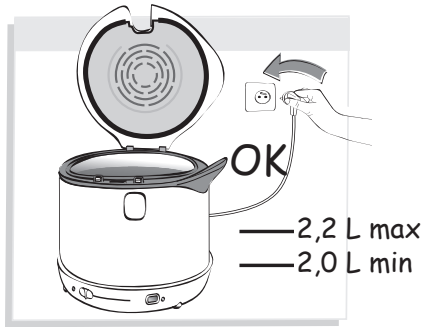
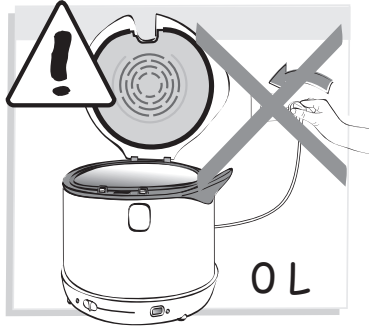























Max 750 g  
380 g







|   | Nb  |    | °C      |    |
|---|---|---|---------|---|
|    |    | 1000g   | ① 160°C | 8-10 min.   |
|   |   |   | ② 190°C | 4-5 min.  |
|    |    | 1000g   | 190°C   | 12-14 min.  |
|    |    | 600g  | 170°C   | 10-12 min.  |
|    |    | 500g  | 190°C   | 7-9 min.  |
|    |   | 3-4   | 180°C   | 16-18 min.  |
|   |   | 2   | 160°C   | 6-8 min.  |
|  |   | 200g  | 150°C   | 6-8 min.  |
|  |   | 4   | 180°C   | 11-13 min.  |
|  |   | 8   | 180°C   | 10-12 min.  |
|  |   | 5   | 170°C   | 5-7 min.  |
| <b>* * *</b>  | Nb  |  | °C      |  |
|  |  | 750g  | 190°C   | 9-11 min.   |
|  |  | 750g  | 170°C   | 10-12 min.  |
|  |  | 380g  | 170°C   | 7-9 min.  |
|  |   | 3-4   | 190°C   | 16-20 min.  |
|  |   | 2   | 160°C   | 5-7 min.  |
|  |   | 200g  | 190°C   | 4-5 min.  |
|  |   | 1 Kg  | 190°C   | 5-7 min.  |
|  |   | 6   | 190°C   | 4-6 min.  |



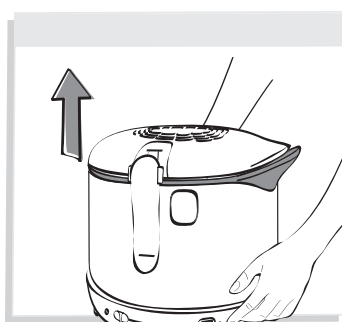
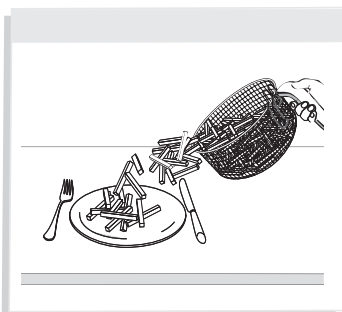
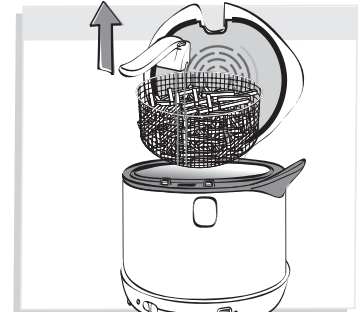
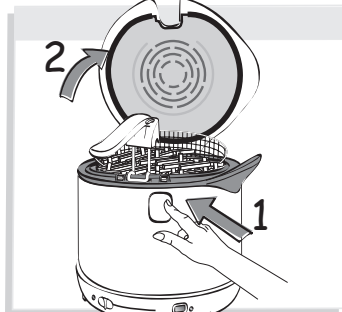
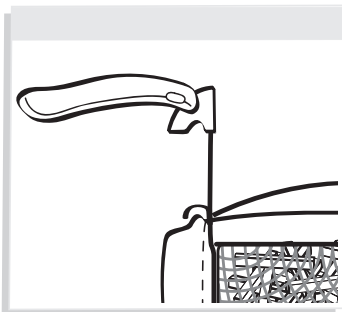
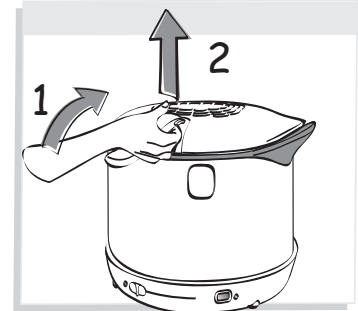
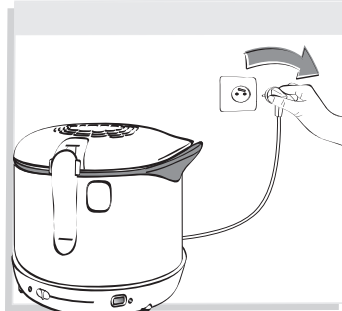
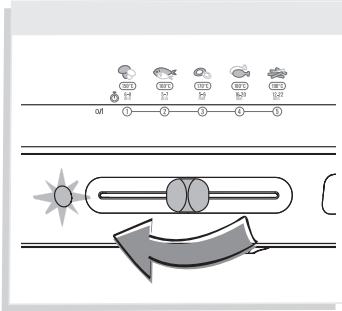

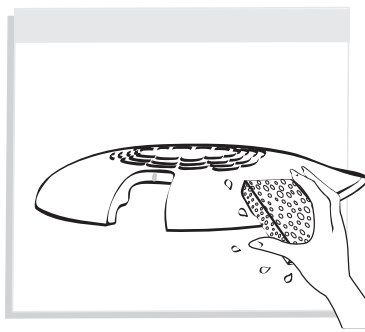
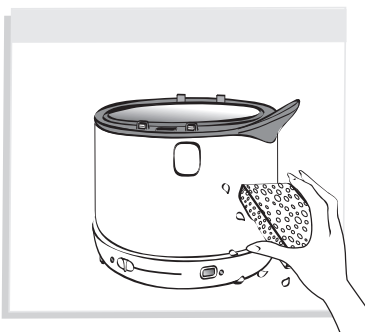
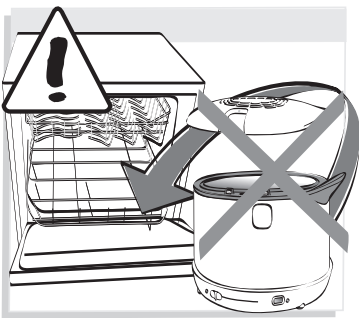
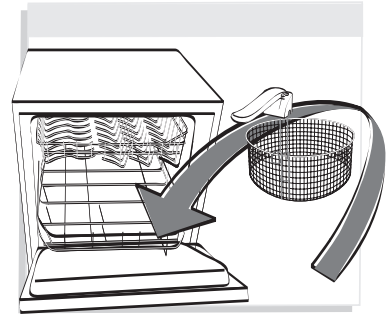
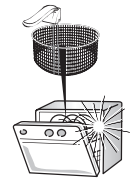

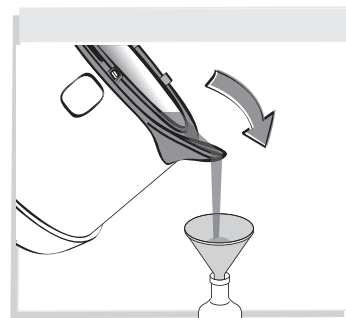
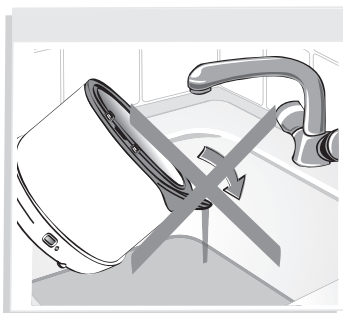

Référence : NC00013428  
Conception : [www.batoteam.fr](http://www.batoteam.fr)

